



2009







Vip cabin









Profilo

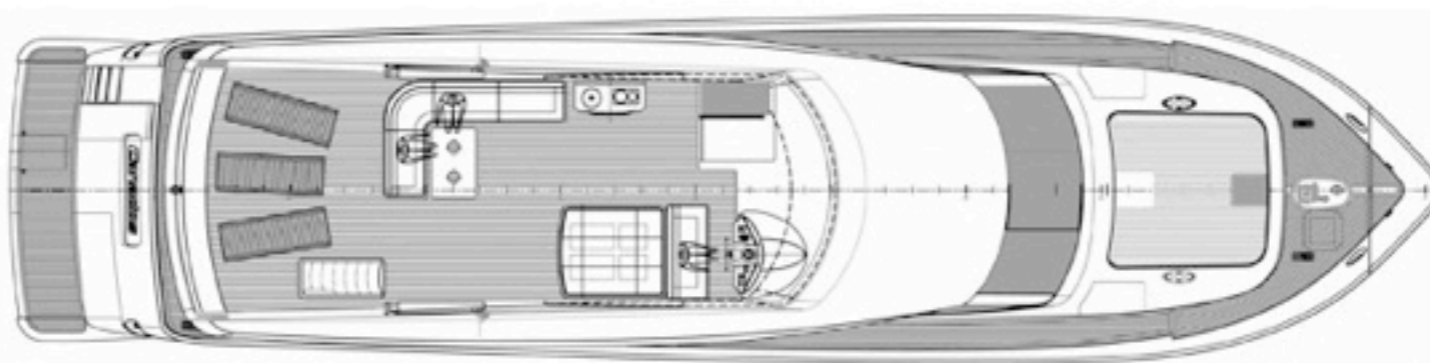

Flyingbridge

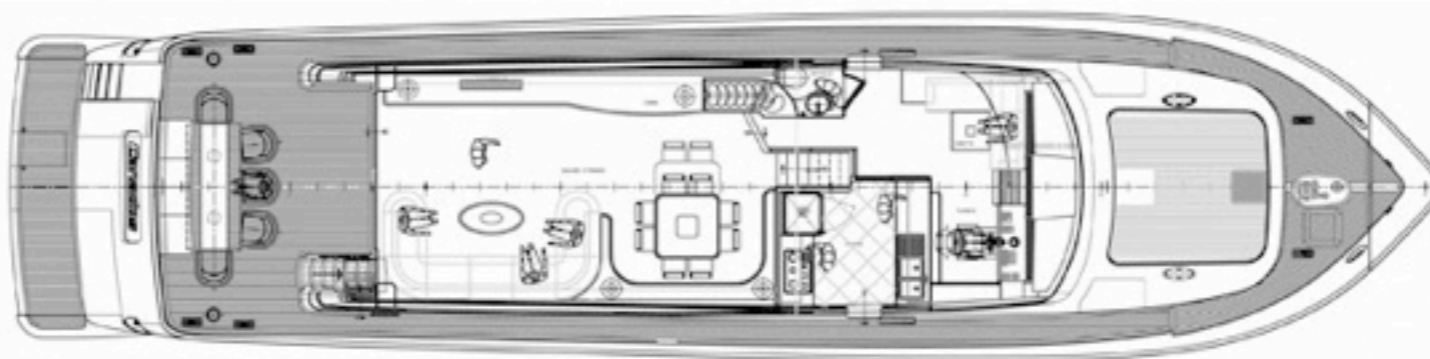

Coperta

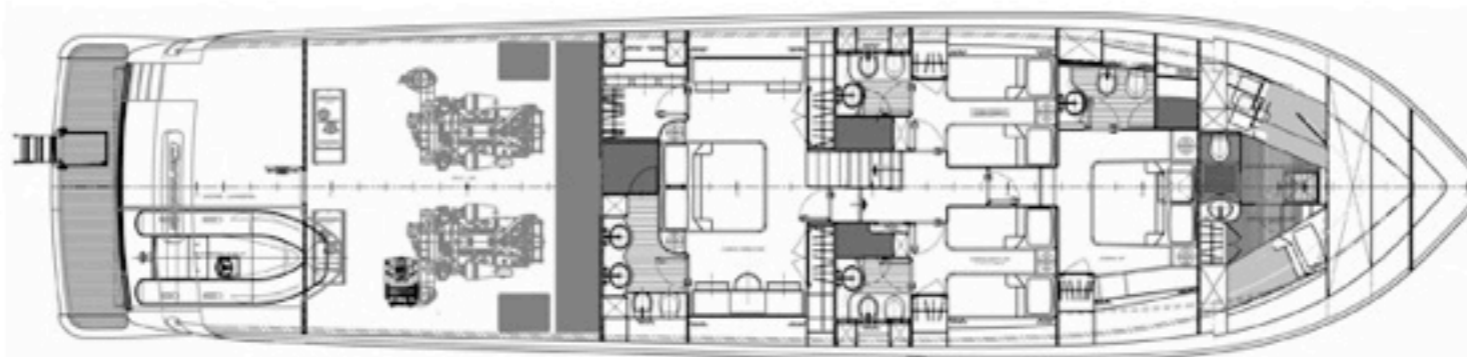

Sottocoperta

Asking Price 2,400,000 € excluding vat

Built :	2009	Hull & Superstructure :	Grp
Loa :	25,80 m	Beam:	6,30 m
Draft :	2,10 m	Full displacement :	75 t
Guest cabins :	4	Crew cabins :	2
Caterpillar	2 X C32	1800 HP X 2	
Shaft		Gear boxes :	ZF 3050 A
Max speed :	33 knots	Cruising Speed :	29 knots
Detra propellers		Generator :	2x Onan 27 kw
Water maker	180 l/h	Air conditioning :	Condaria
Fuel tanks	7800 l	Water capacity :	1000 l
Safe (master and captain cabins)		Underwater lights X 4	
Bimini top		Williams Turbojet tender	
Portside cabin with pullman		Dimmer in all cabins	
Stern thruster		Bow thruster	
MCA Charter Class		Kinetico 50 softener	
TV in saloon		TV in all cabins	
Bow bimini		Wine cooler	
Seatel 2498 satellite TV antenna		decoder in saloon	
Wind station		Hamman Kit	
Search light X 2			
Depthsounder		Log-speedometer	
Repeater(s)		Navigation center	
Plotter		Auto pilot	
Compass		Gps	
VHF		Radar	
Radar detector		Computer	
TV Set		DVD Player	
Radio		CD Player	